

**GAUT • WHITTENBURG • EMERSON**

Commercial Real Estate

**806-373-3111**

[www.gwamarillo.com](http://www.gwamarillo.com)



# FOR LEASE

1900 S Coulter, Suite O, Amarillo, TX

On Fleming Street Side

## MEDICAL OFFICE



**SPACE AVAILABLE:** 2,802 sf

**LEASE RATE:** \$3,269 / month (\$14.00 / sf / year)  
includes condo fees

- Great facility for 2 - 3 doctors
- 7 exam rooms
- 3 bathrooms
- 1 center core office
- 3 provider offices
- Centrally located in SW Medical area close to Kindred, BSA and Northwest Texas Hospitals



This information has been secured from sources we believe to be reliable, but we make no representation or warranties, expressed or implied, as to the accuracy of the information. References to measurements are approximate. Buyer must verify the information and bears all risks for inaccuracies.

This property is represented by:  
**CATHY DERR CCIM**  
[cathy@gwamarillo.com](mailto:cathy@gwamarillo.com) • 806-373-3111

**GAUT · WHITTENBURG · EMERSON**

Commercial Real Estate

**806-373-3111**

www.gwamarillo.com



# FOR LEASE

1900 S Coulter, Suite O, Amarillo, TX

On Fleming Street Side

## MEDICAL OFFICE

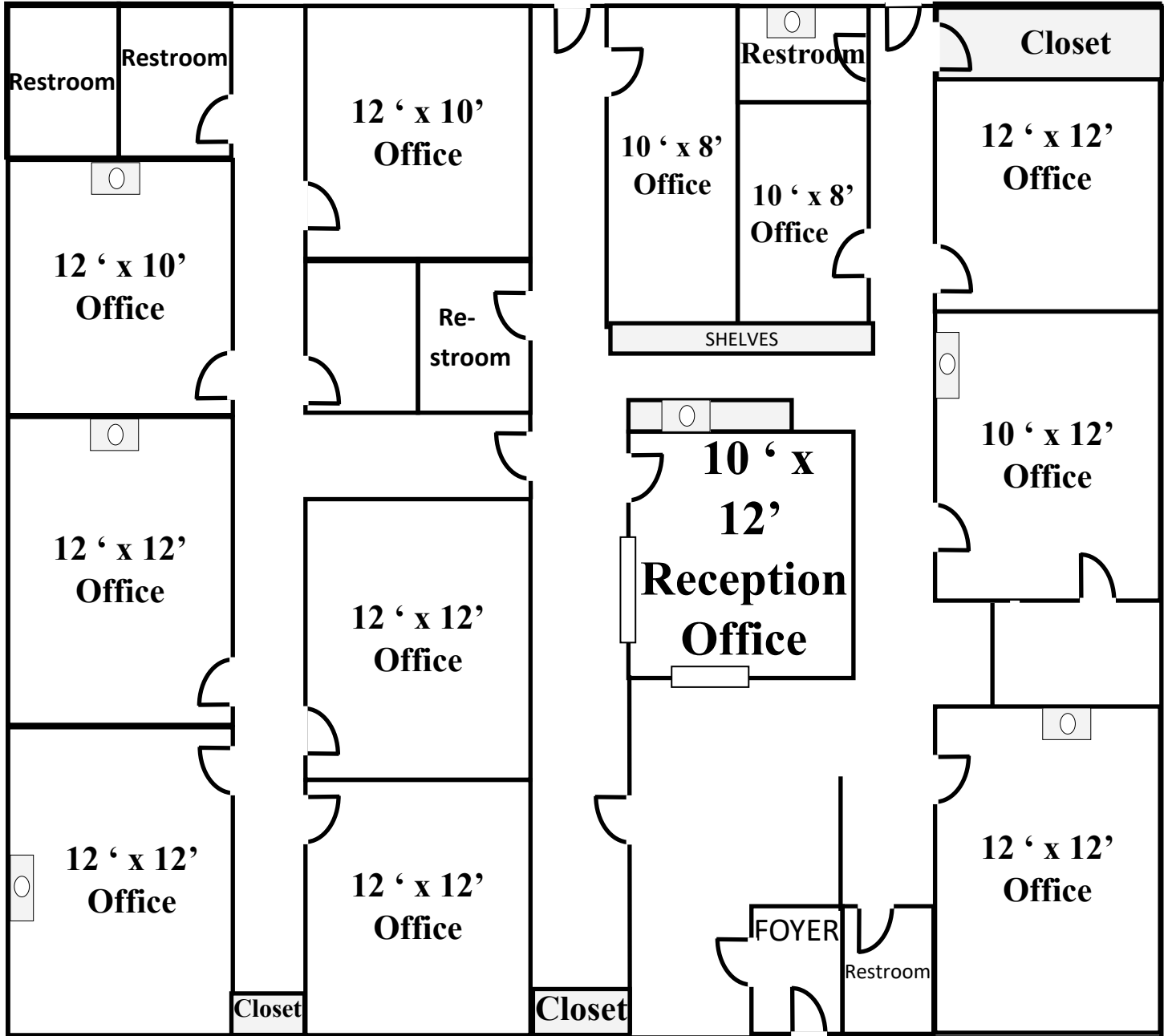

This information has been secured from sources we believe to be reliable, but we make no representation or warranties, expressed or implied, as to the accuracy of the information. References to measurements are approximate. Buyer must verify the information and bears all risks for inaccuracies.

This property is represented by:  
**CATHY DERR CCIM**  
cathy@gwamarillo.com • 806-373-3111